

ZOO PARK ROAD

WALLY DRIVE

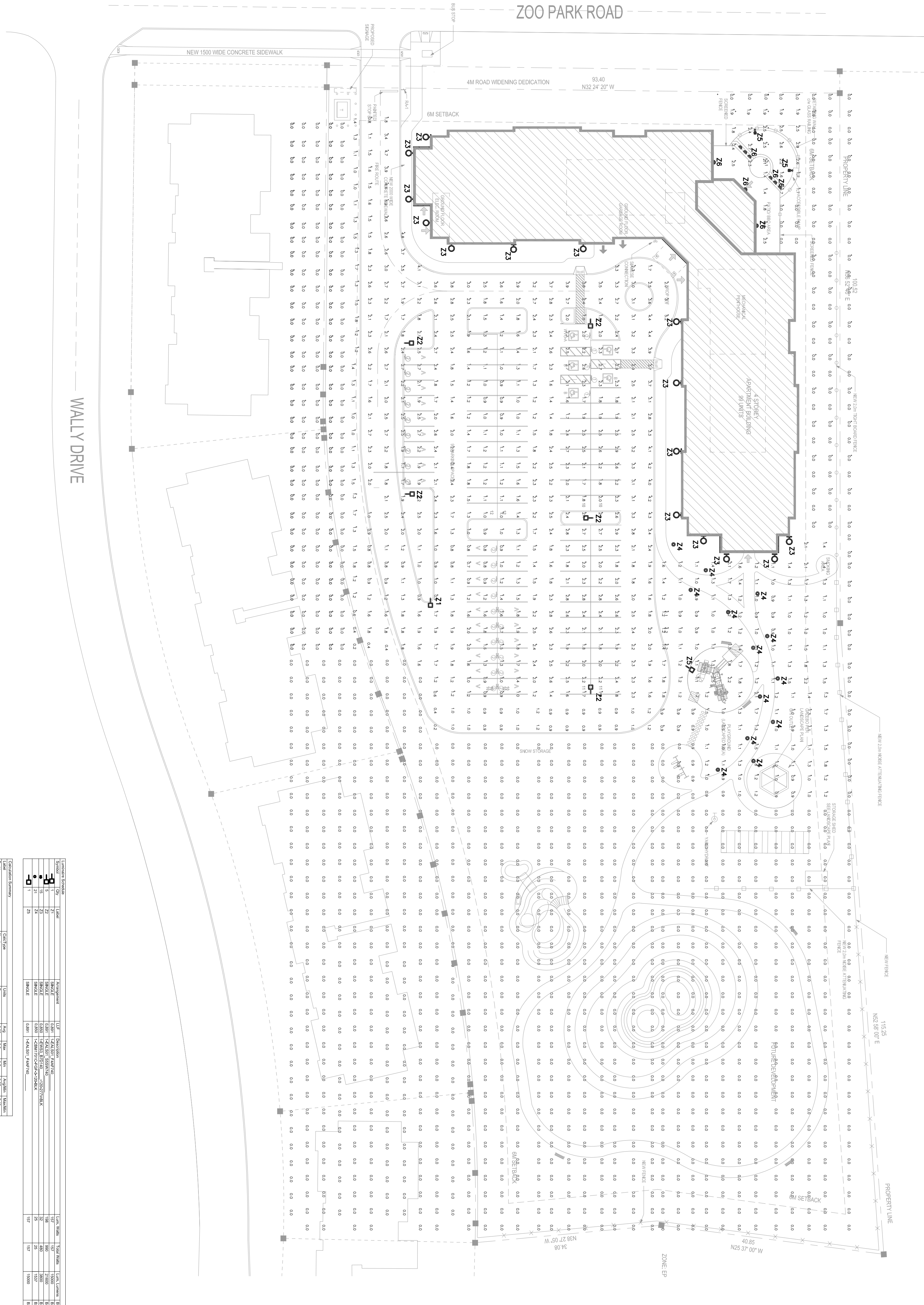

Lot No.	Lot Area (sq. ft.)	Lot Area (sq. m.)	Lot No.	Lot Area (sq. ft.)	Lot Area (sq. m.)
1	1000	93	11	1000	93
2	1000	93	12	1000	93
3	1000	93	13	1000	93
4	1000	93	14	1000	93
5	1000	93	15	1000	93
6	1000	93	16	1000	93
7	1000	93	17	1000	93
8	1000	93	18	1000	93
9	1000	93	19	1000	93
10	1000	93	20	1000	93
21	1000	93	31	1000	93
22	1000	93	32	1000	93
23	1000	93	33	1000	93
24	1000	93	34	1000	93
25	1000	93	35	1000	93
26	1000	93	36	1000	93
27	1000	93	37	1000	93
28	1000	93	38	1000	93
29	1000	93	39	1000	93
30	1000	93	40	1000	93
41	1000	93	51	1000	93
42	1000	93	52	1000	93
43	1000	93	53	1000	93
44	1000	93	54	1000	93
45	1000	93	55	1000	93
46	1000	93	56	1000	93
47	1000	93	57	1000	93
48	1000	93	58	1000	93
49	1000	93	59	1000	93
50	1000	93	60	1000	93

I HEREBY CERTIFY THAT THE OUTDOOR LIGHTING EQUIPMENT AND FIXTURES DESIGNED HEREIN COMPLY WITH DARK SKY REQUIREMENTS

LIGHTING FIXTURE SCHEDULE

- Z1 GE LIGHTING CAFE/MS-02-120-H4AF-7-40-0-01-BLCK-U-R COVER-SURE GUARD PROTECTOR-BLACK 1-800-756-3537
- Z2 GE LIGHTING CAFE/MS-02-120-SSSW-7-40-0-01-BL-U-R COVER-SURE GUARD PROTECTOR-BLACK 1-800-756-3537
- Z3 GE LIGHTING CAFE/MS-120-B7D1-40-1-BLCK-U-1
- Z4 PATHWAY LIGHT BOLLARD GE CAFE1-CBM701C-60-3-120-BLK
- Z5 SIMILAR TO TYPE Z1 MOUNTED ON A 10' POLE
- Z6 GE STEP LIGHT

NOTES:

- CLASS OF CONCRETE
- ANCHOR BOLTS SHALL CHECK NUMBER OF ANCHOR BOLTS, AND BOLT CIRCLE PLACING CONCRETE POLE FROM TO WITH WOODEN OR STEEL TRAPLATES.
- ANCHORAGE ASSEMBLY SHALL BE PROVIDED WITH WOODEN OR STEEL TRAPLATES.
- ANCHOR BOLTS ARE ROUND BARS CONCRETE NOT TO EXCEED 1.2m BELOW FINISH GRADE. ANCHOR BOLTS SHALL BE SUFFICIENTLY MARKED ON TOP OF FOOTING.
- POLE ANCHOR BOLTS SHALL BE VERTICALLY INSTALLED IN THE FORMER ALIGNED WITH CONCRETE PLACEMENT.
- CONCRETE TO BE PLACED AGAINST THE EXTERIOR SURFACE OF THE CONCRETE. THE STEEL LINER OF THE EXHAUSTOR OR OTHER SUITABLE METHOD. THE LINER SHALL BE REMOVED AS THE CONCRETE IS POURED.

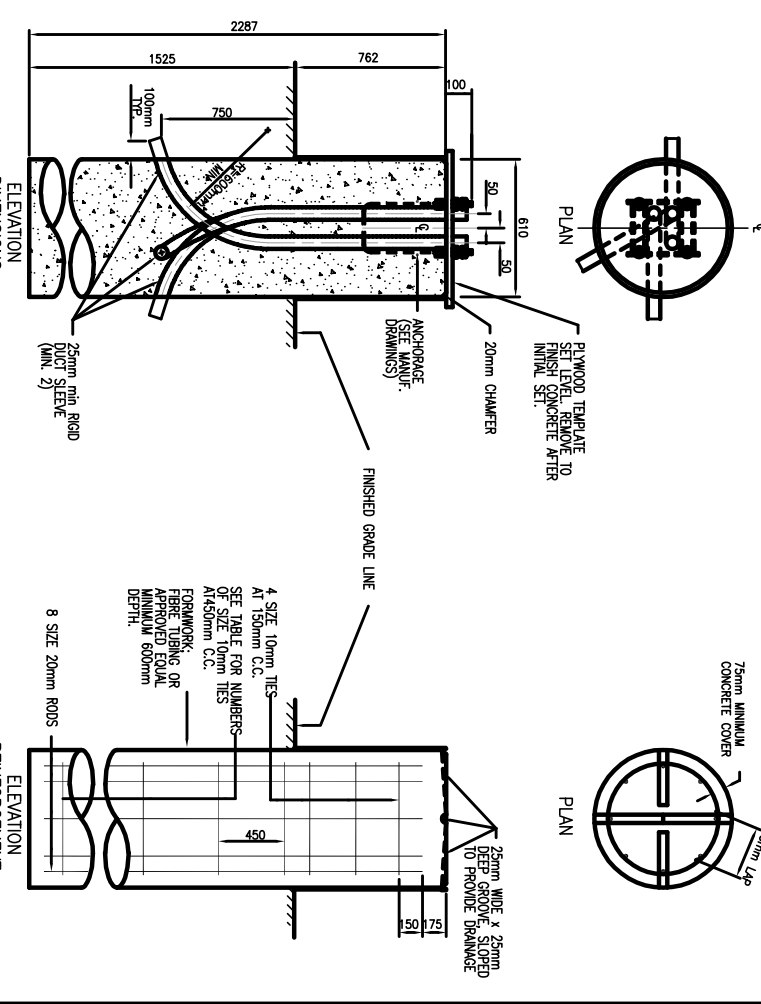

ANCHORAGE ASSEMBLY FOR MEDIUM MAST LIGHTING POLE INSTALLATION
 A.A. OBERFELD
 LICENSED PROFESSIONAL ENGINEER
 011118
 PROVINCE OF ONTARIO

NOTE: CONCRETE BASE TO BE SUPPLIED WITH PROTECTOR COVER-BLACK
 -800-756-3537

No.	REVISION	DATE
1.	ISSUED FOR SITE PLAN APPROVAL	SEP/29/17
2.	SITE PLAN APPROVAL	NOV. 17/17
3.	SITE PLAN 1ST SUBMISSION COMMENTS	DEC 4/17
4.	SITE PLAN 2ND SUBMISSION COMMENTS	JAN 11/18

ALL DIMENSIONS TO BE CHECKED & VERIFIED ON SITE. DISCREPANCIES TO BE REPORTED TO THE ARCHITECT LATEST APPROVED STAMPED DRAWINGS ONLY. TO BE USED FOR CONSTRUCTION.

TRISTAR ENGINEERING
 174 ZOO PARK ROAD
 WASAGA BEACH, ONTARIO

PROJECT NAME:
 WASAGA BEACH AFFORDABLE HOUSING

COUNTY OF SIMCOE
 DATE: SEP. 2017
 DRAWN BY: DP/JP
 SCALE: 1:400

JOB NO. 2017-135
 SHEET NO. LE1