

Adopted by Council: September 9, 2003
 Approved by the County of Simcoe: June 22, 2004
 Consolidated: January 2020

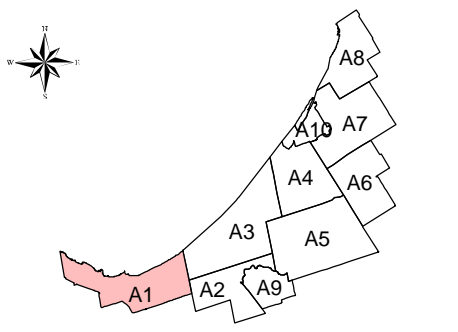

Legend

	Residential		Tourism Accommodation
	High Density Residential		Tourism Commercial
	Country Club Community		Institutional
	Campground Commercial		Open Space
	Recreational Commercial		Natural Hazards
	Service Commercial		Natural Heritage System Category 1
	District Commercial		Rural
	Local Commercial		Waste Disposal

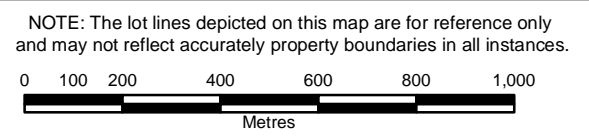

Schedule 'A-1'

Land Use Plan

Official Plan of the Town of Wasaga Beach



Adopted by Council: September 9, 2003
 Approved by the County of Simcoe: June 22, 2004
 Consolidated: January 2020

NOTE: The lot lines depicted on this map are for reference only and may not reflect accurately property boundaries in all instances.

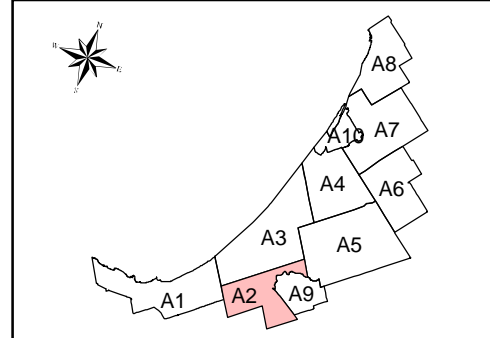

Legend

Residential	Tourism Accommodation
High Density Residential	Tourism Commercial
Country Club Community	Institutional
Campground Commercial	Open Space
Recreational Commercial	Natural Hazards
Service Commercial	Natural Heritage System Category 1
District Commercial	Rural
Local Commercial	Waste Disposal



Schedule 'A-2' Land Use Plan

Official Plan of the Township of Wasaga Beach



Adopted by Council: September 9, 2003
 Approved by the County of Simcoe: June 22, 2004
 Consolidated: January 2020

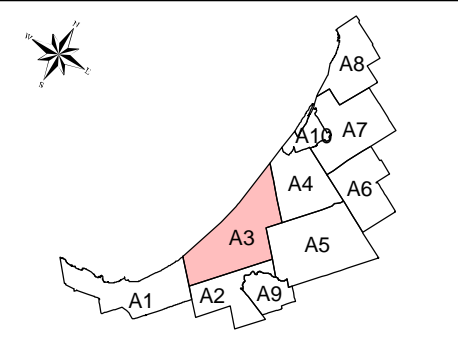
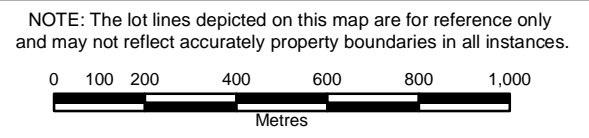

Legend

Residential	Tourism Accommodation
High Density Residential	Tourism Commercial
Country Club Community	Institutional
Campground Commercial	Open Space
Recreational Commercial	Natural Hazards
Service Commercial	Natural Heritage System Category 1
District Commercial	Rural
Local Commercial	Waste Disposal



Schedule 'A-3' Land Use Plan

Official Plan of the Town of Wasaga Beach



Adopted by Council: September 9, 2003
 Approved by the County of Simcoe: June 22, 2004
 Consolidated: January 2020

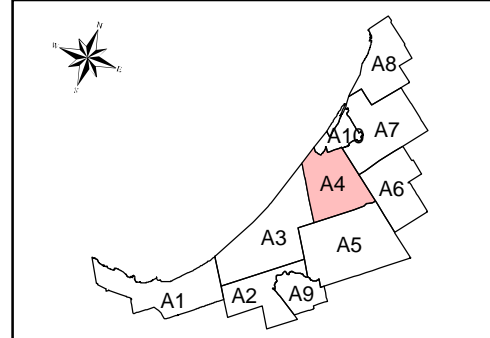
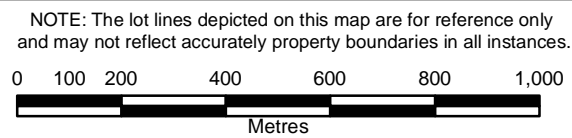

Legend

Residential	Tourism Accommodation
High Density Residential	Tourism Commercial
Country Club Community	Institutional
Campground Commercial	Open Space
Recreational Commercial	Natural Hazards
Service Commercial	Natural Heritage System Category 1
District Commercial	Rural
Local Commercial	Waste Disposal



Schedule 'A-4' Land Use Plan

Official Plan of the Town of Wasaga Beach

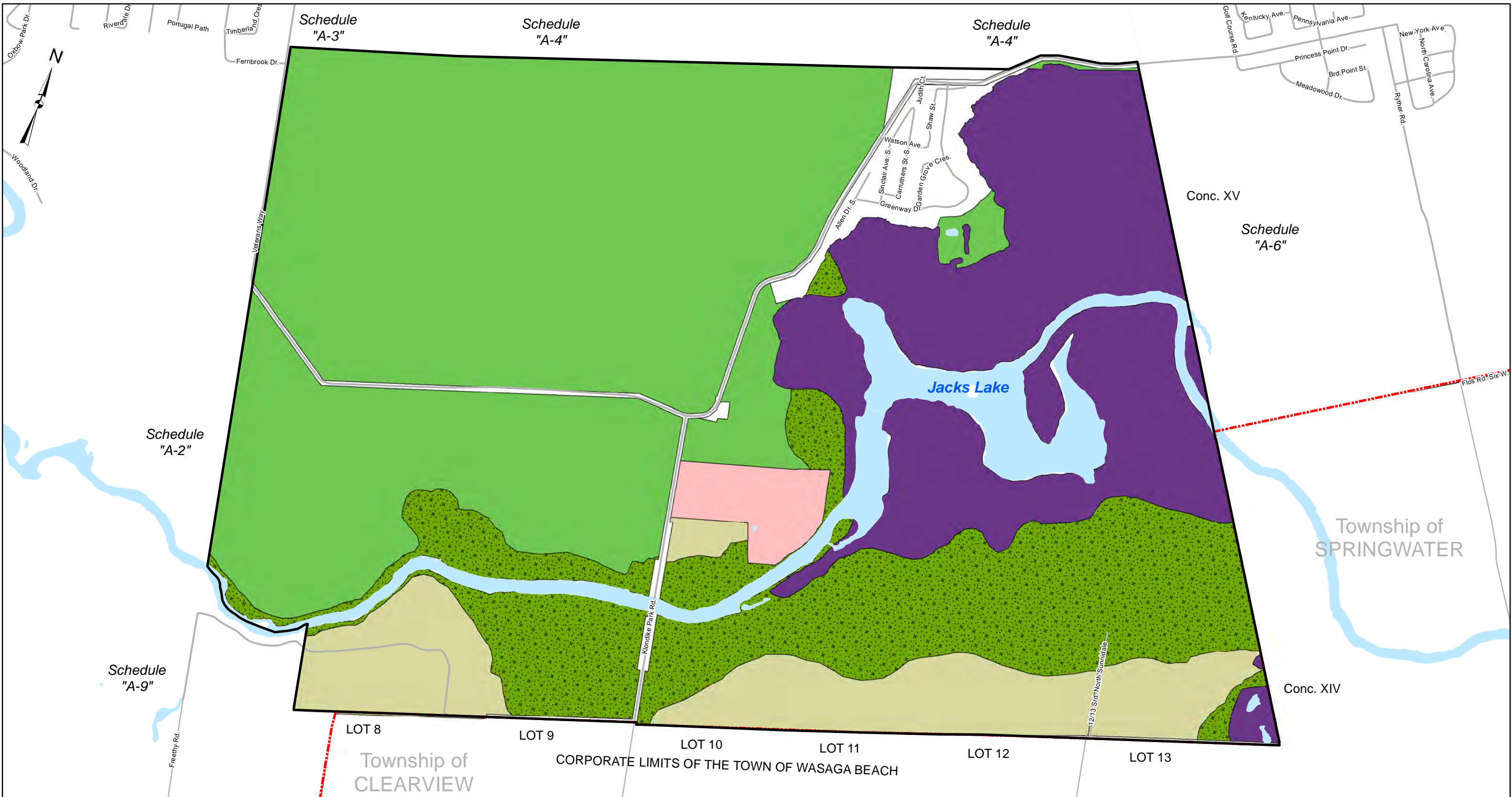

Adopted by Council: September 9, 2003
 Approved by the County of Simcoe: June 22, 2004
 Consolidated: January 2020

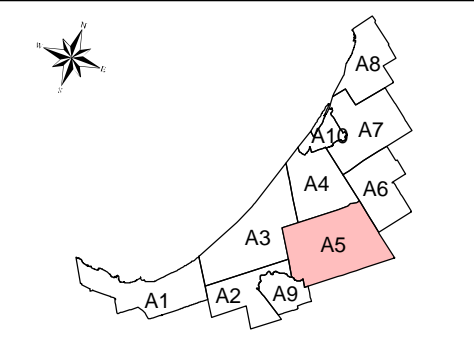
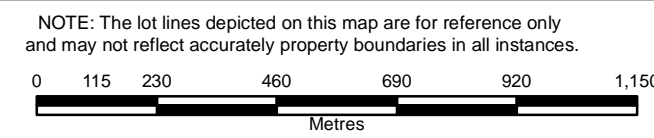

Legend

Residential	Tourism Accommodation
High Density Residential	Tourism Commercial
Country Club Community	Institutional
Campground Commercial	Open Space
Recreational Commercial	Natural Hazards
Service Commercial	Natural Heritage System Category 1
District Commercial	Rural
Local Commercial	Waste Disposal

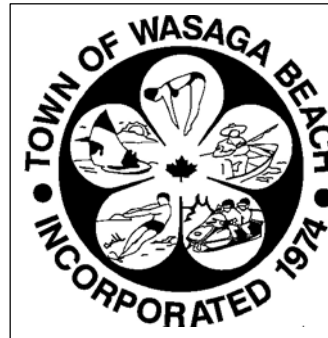

Schedule 'A-5' Land Use Plan

Official Plan for the Town of Wasaga Beach



Adopted by Council: September 9, 2003
 Approved by the County of Simcoe: June 22, 2004
 Consolidated: January 2020

NOTE: The lot lines depicted on this map are for reference only and may not reflect accurately property boundaries in all instances.

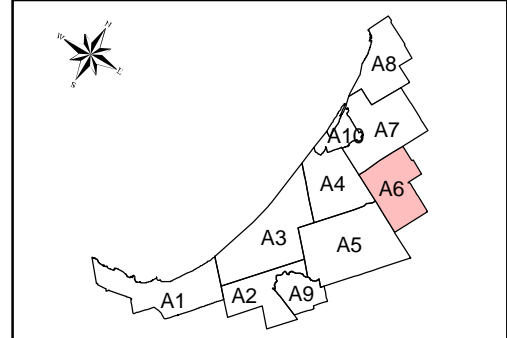

Legend

Residential	Tourism Accommodation
High Density Residential	Tourism Commercial
Country Club Community	Institutional
Campground Commercial	Open Space
Recreational Commercial	Natural Hazards
Service Commercial	Natural Heritage System Category 1
District Commercial	Rural
Local Commercial	Waste Disposal



Schedule 'A-6'

Land Use Plan

Official Plan for the Township of Wasaga Beach

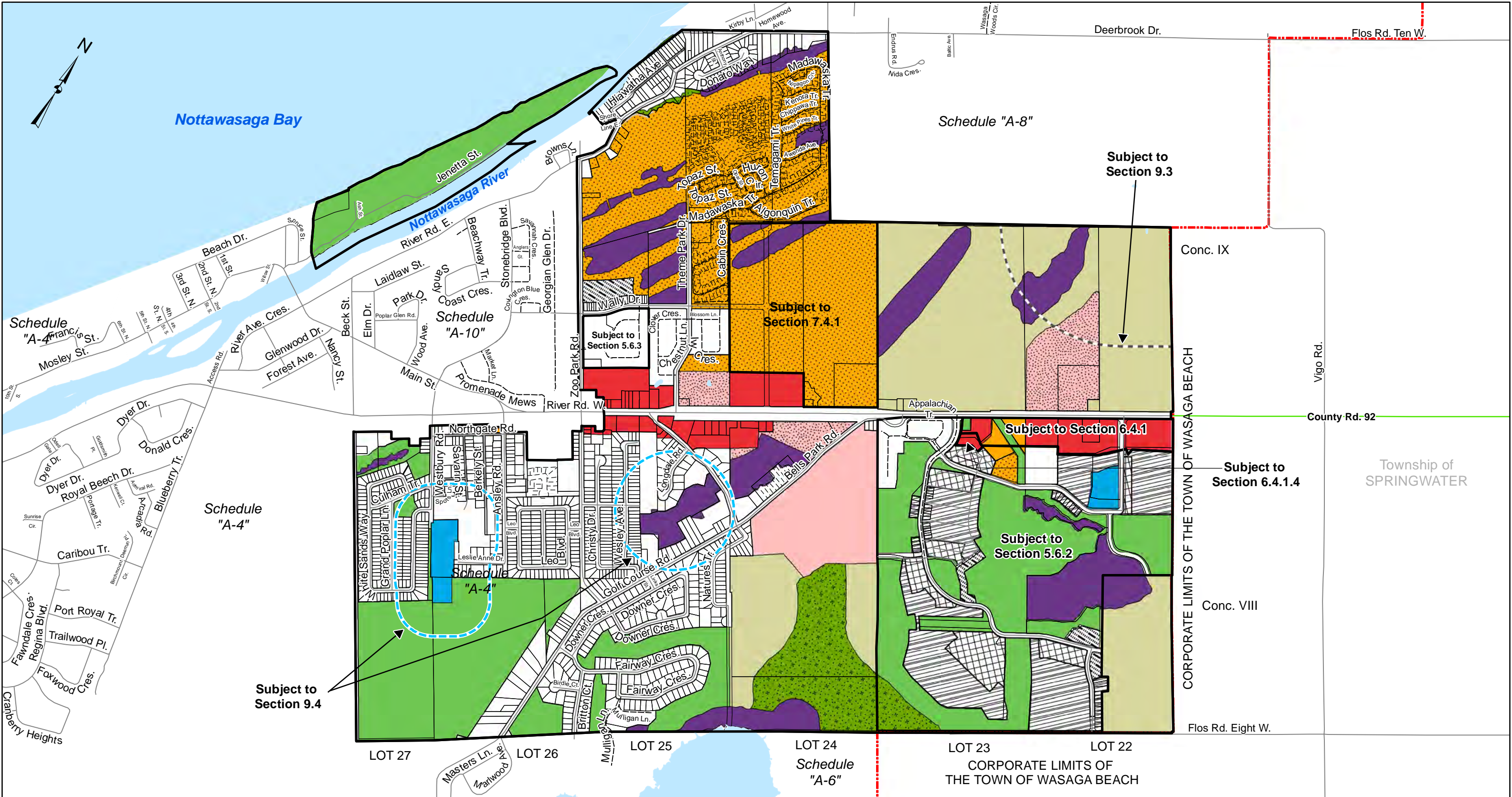

Adopted by Council: September 9, 2003
 Approved by the County of Simcoe: June 22, 2004
 Consolidated: January 2020

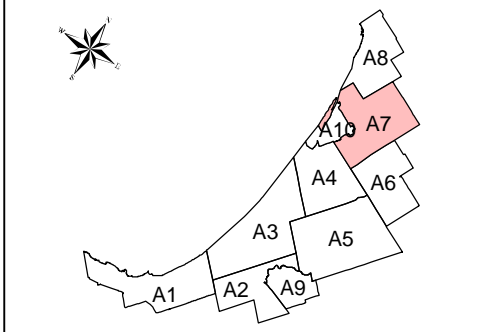
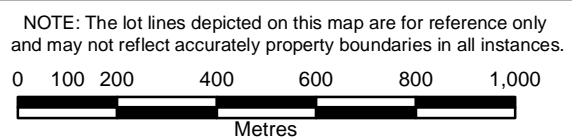

Waste Disposal Assessment Area	District Commercial
Special Hydrogeological Study Area	Local Commercial
Residential	Tourism Accommodation
Low Density Residential	Tourism Commercial
Medium Density Residential	Institutional
High Density Residential	Open Space
Country Club Community	Natural Hazards
Campground Commercial	Natural Heritage System Category 1
Recreational Commercial	Rural
Service Commercial	Waste Disposal



Schedule 'A-7' Land Use Plan

Official Plan of the Town of Wasaga Beach

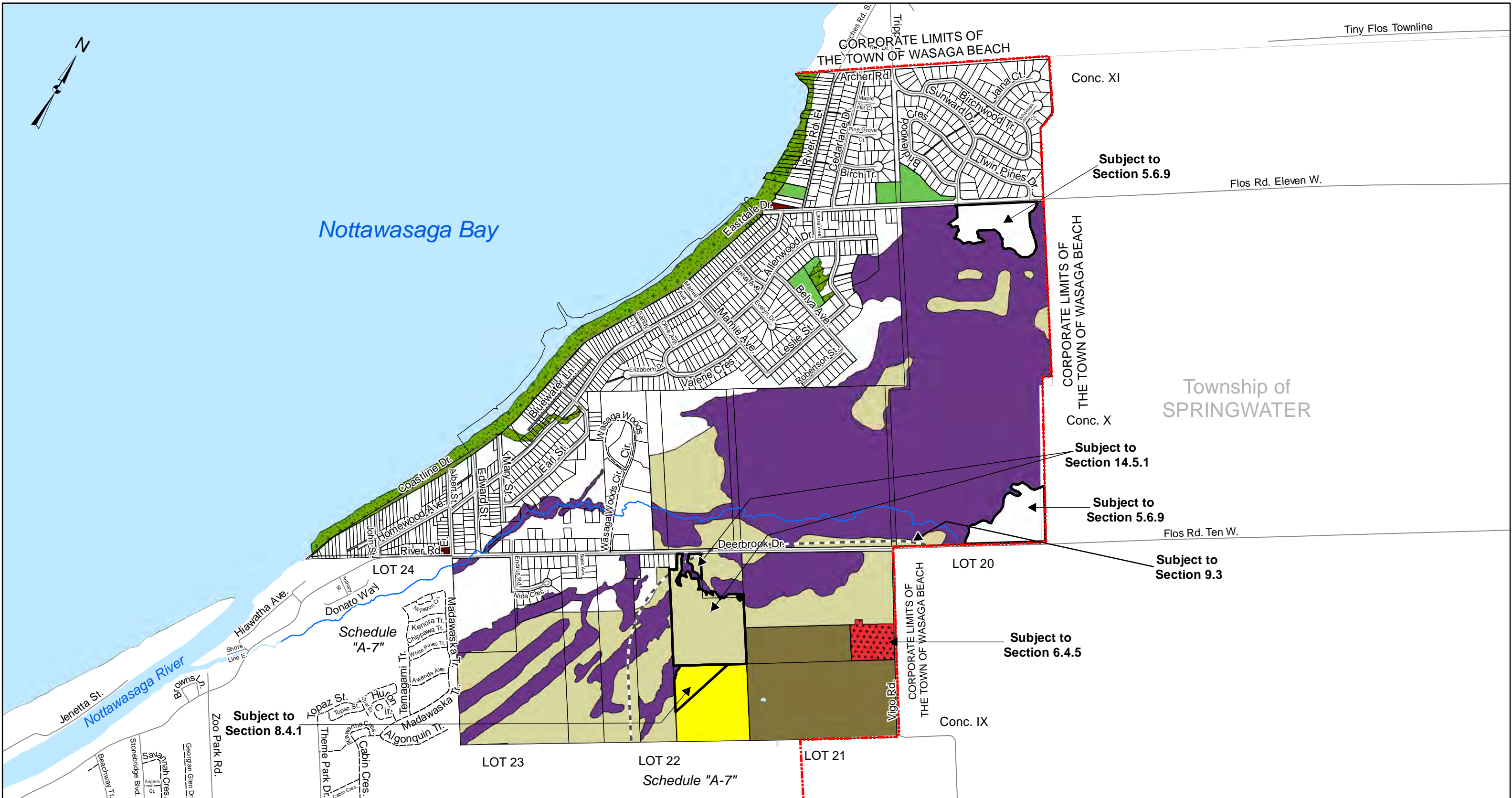

Adopted by Council: September 9, 2003
 Approved by the County of Simcoe: June 22, 2004
 Consolidated: January 2020

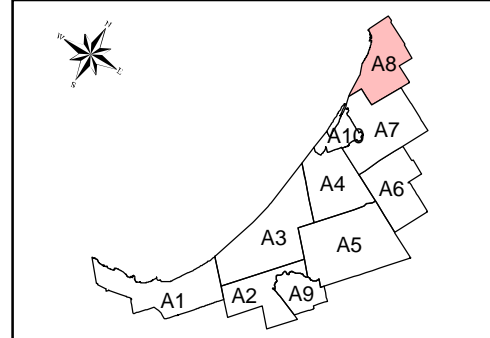
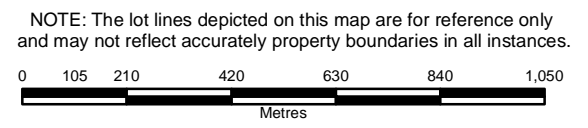

Waste Disposal Assessment Area	Industrial
Residential	Tourism Accommodation
High Density Residential	Tourism Commercial
Country Club Community	Institutional
Campground Commercial	Open Space
Recreational Commercial	Natural Hazards
Service Commercial	Natural Heritage System Category 1
District Commercial	Rural
Local Commercial	Waste Disposal



Schedule 'A-8' Land Use Plan

Official Plan for the Town of Wasaga Beach

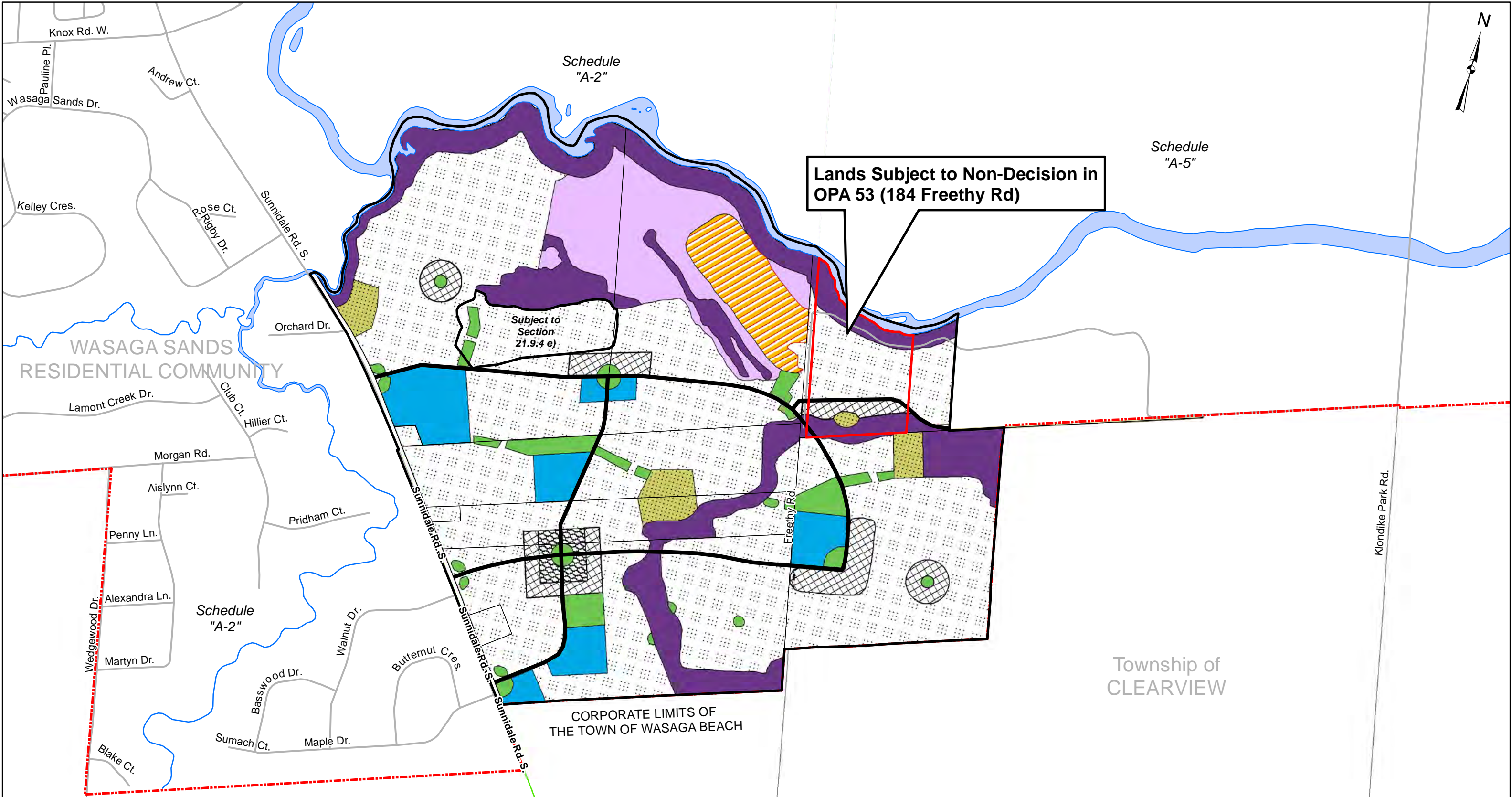

Adopted by Council: September 9, 2003
 Approved by the County of Simcoe: June 22, 2004
 Consolidated: January 2020

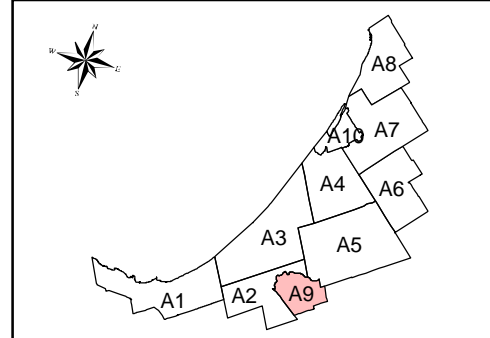
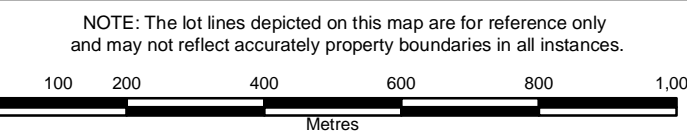

Legend

Collector Roads	Open Space
Low Density Residential	Natural Hazards
Medium Density Residential	Natural Heritage System Category 1
High Density Residential	Natural Heritage System Category 2
Community Centre	Special Study Area (Subject to Section 21.6.2 b))
Institutional	Storm Water Management Pond



Schedule 'A-9'

Land Use Plan

Official Plan of the Town of Wasaga Beach

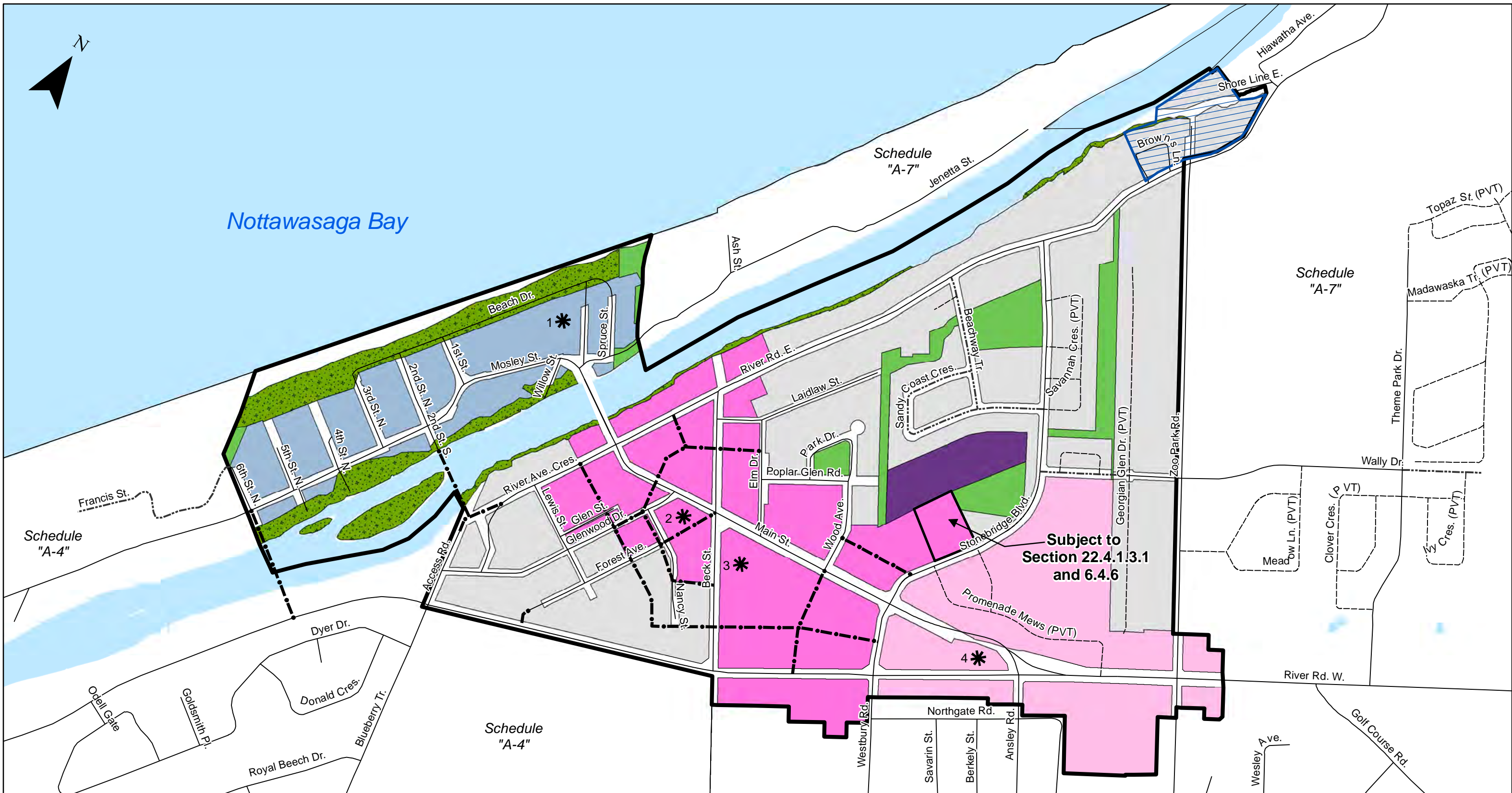

Adopted by Council: September 9, 2003

Approved by the County of Simcoe: June 22, 2004

Consolidated: January 2020

NOTE: The lot lines depicted on this map are for reference only and may not accurately reflect property boundaries in all instances.

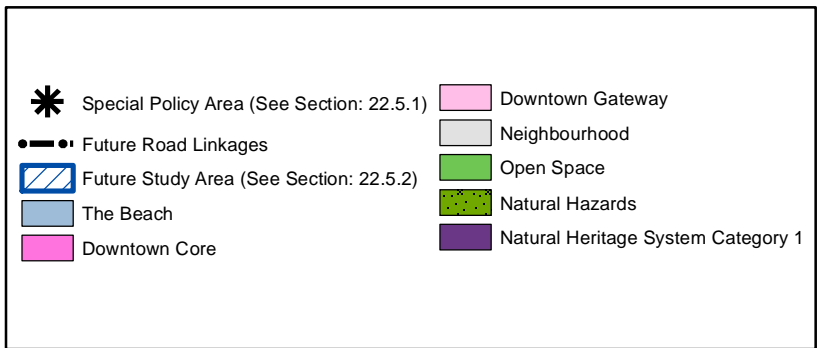
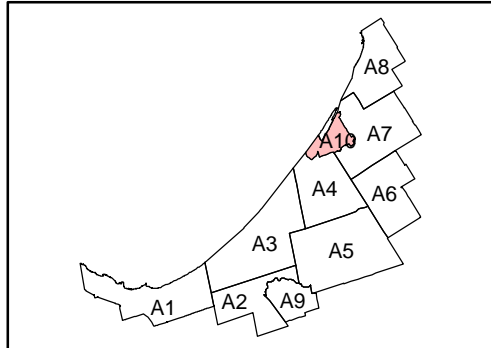
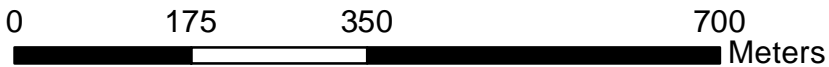

SCHEDULE 'A-10' Land Use Plan

Official Plan of the Town of Wasaga Beach

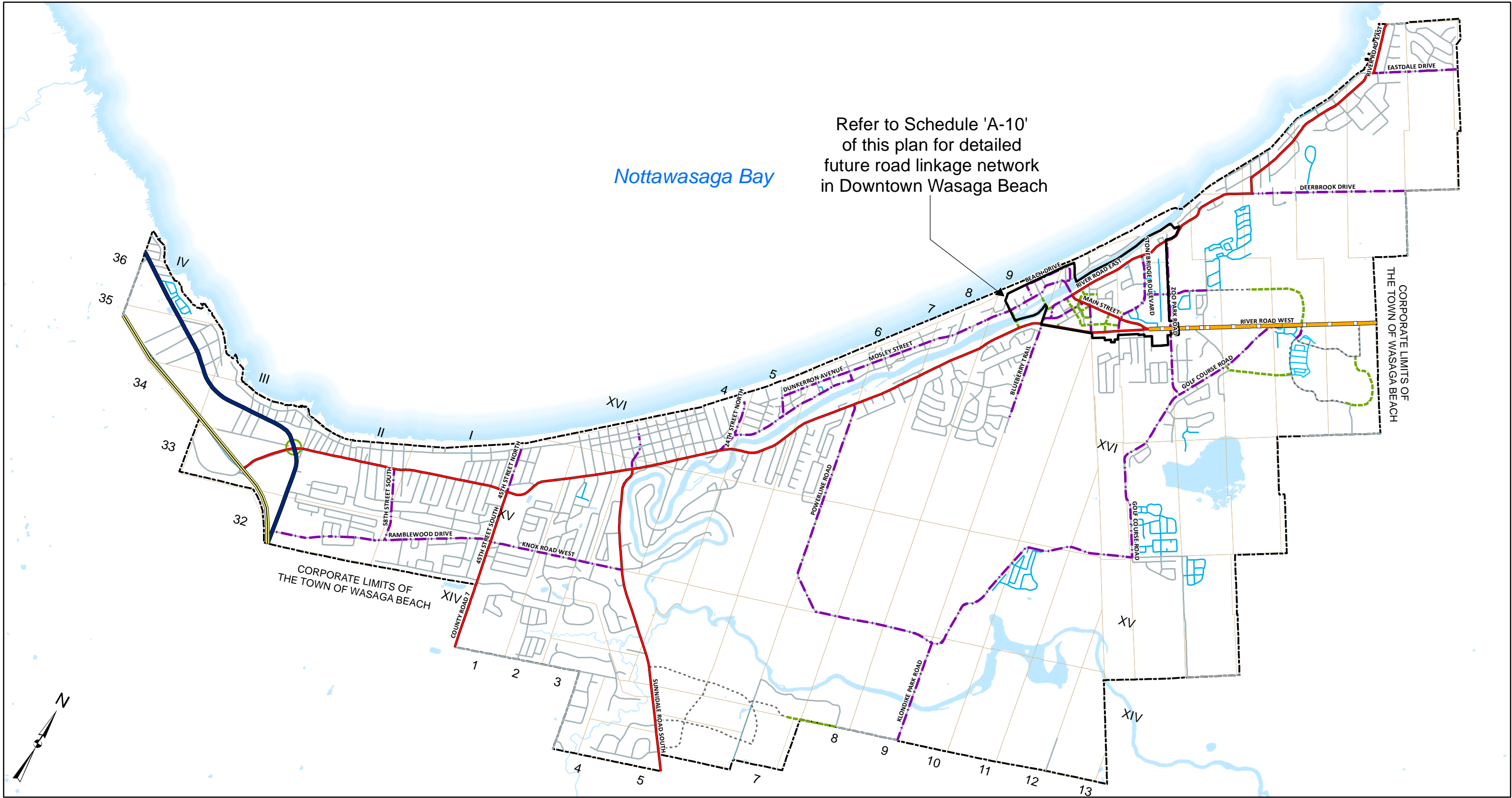

Adopted by Council: September 9, 2003
 Approved by the County of Simcoe: June 22, 2004
 Consolidated: January 2020

NOTE: The lot lines depicted on this map are for reference only and may not reflect accurately property boundaries in all instances.

0 300 600 1,200 1,800 2,400 3,000
 Metres

- Legend**
- █ Provincial Highway/Future Collector Road
 - █ Provincial Highway 26
 - Planned Interchange
 - █ Controlled Access
 - █ Arterial Road
 - █ Collector Road
 - █ Local Municipal Road
 - █ Private Local Road
 - ⋯ Planned Collector Road (Not Built)
 - - - Future Road Linkage



Schedule 'B'

Transportation System

Official Plan for the Town of Wasaga Beach

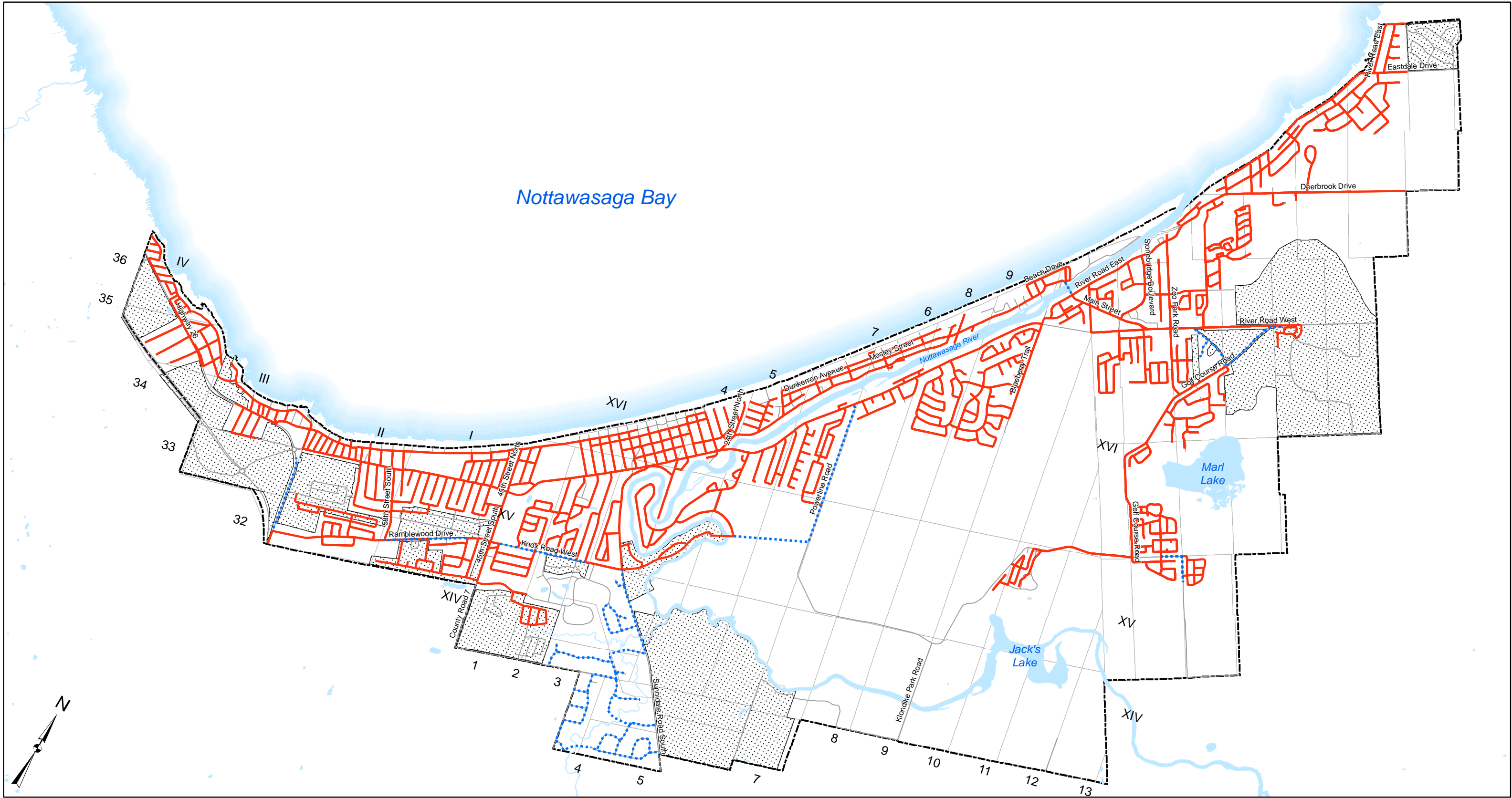

Adopted by Council: September 9, 2003
 Approved by the County of Simcoe: June 22, 2004
 Consolidated: January 2020

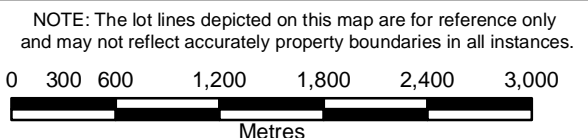

- Water Servicing Only
- Water and Sewer Servicing
- Future Staging Areas



Schedule 'C'

Municipal Servicing Area

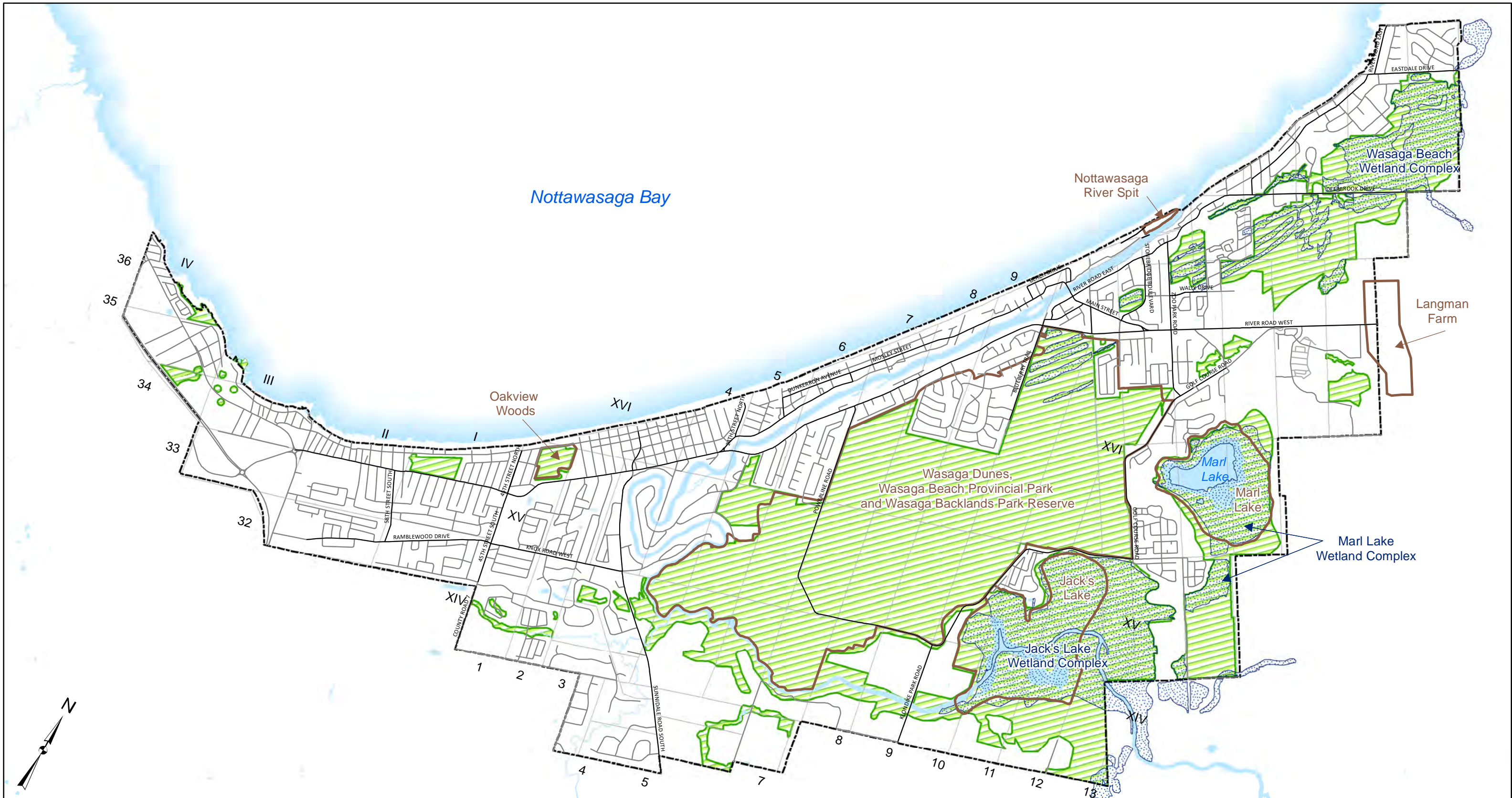

Official Plan for the Town of Wasaga Beach



Adopted by Council: September 9, 2003
 Approved by the County of Simcoe: June 22, 2004
 Consolidated: January 2020

NOTE: The lot lines depicted on this map are for reference only and may not reflect accurately property boundaries in all instances.

0 300 600 1,200 1,800 2,400 3,000
 Metres

-  ANSI (Area of Natural and Scientific Interest)
-  Provincially Significant Wetland Complex
-  Natural Heritage System Category 1 and 2 Lands



Schedule 'D'
Natural Heritage System
 Official Plan of the Town of Wasaga Beach



NOTTAWASAGA BAY

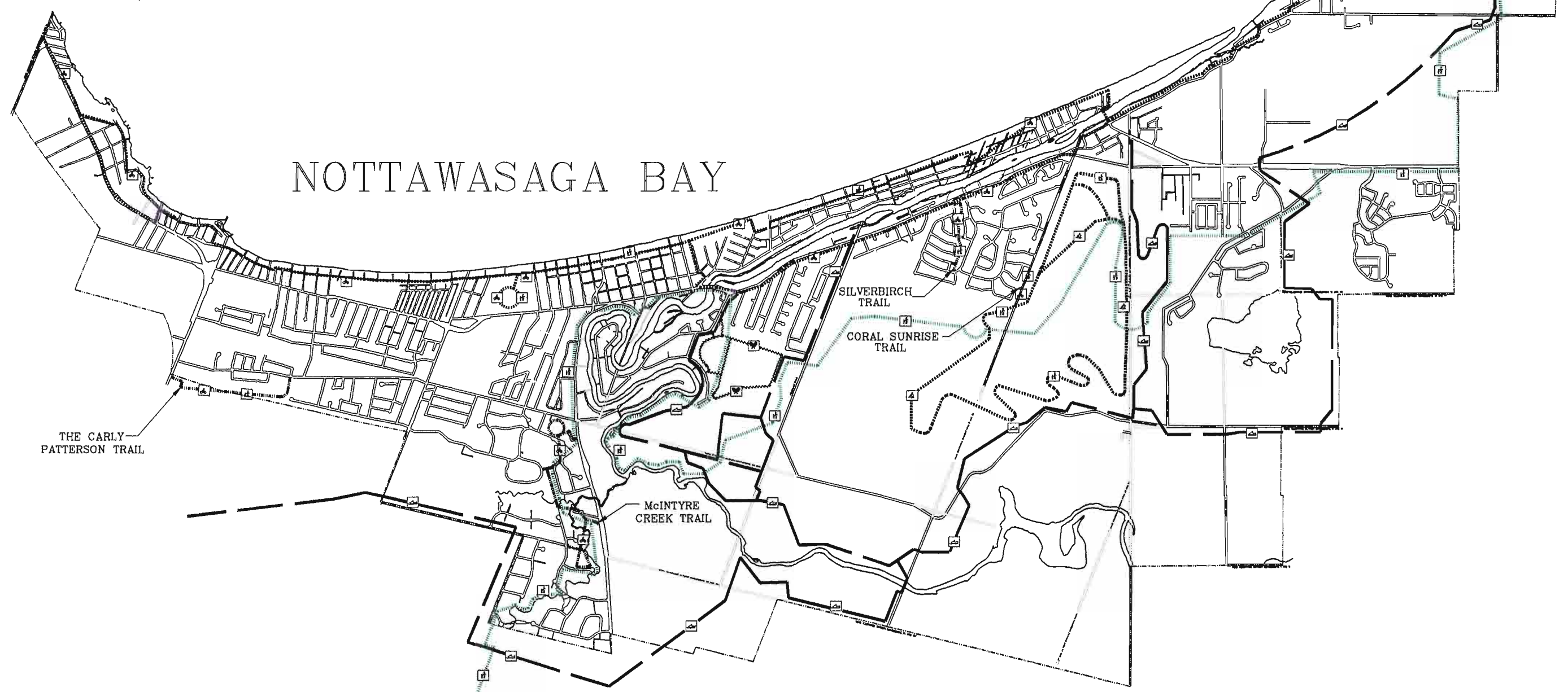

THE CARLY PATTERSON TRAIL

McINTYRE CREEK TRAIL

SILVERBIRCH TRAIL

CORAL SUNRISE TRAIL

**REINDERS
SOUTHPARK**

SCALE



October 2004

LEGEND

- SNOWMOBILE TRAIL
- COMMUNITY TRAILS
- GANARASKA HIKING TRAIL
- CENTRAL DUNES SNOWSHOE TRAIL
- THE BEACHES LOOP
A shared right-of-way, with bicycle traffic sharing the roadway with motor vehicles
- BLUEBERRY PLAINS
CROSS COUNTRY SKI TRAILS (SEASONAL USES)

TOWN OF



WASAGA BEACH

Schedule 'E'

RECREATIONAL TRAILS SYSTEM

OFFICIAL PLAN FOR THE
TOWN OF WASAGA BEACH

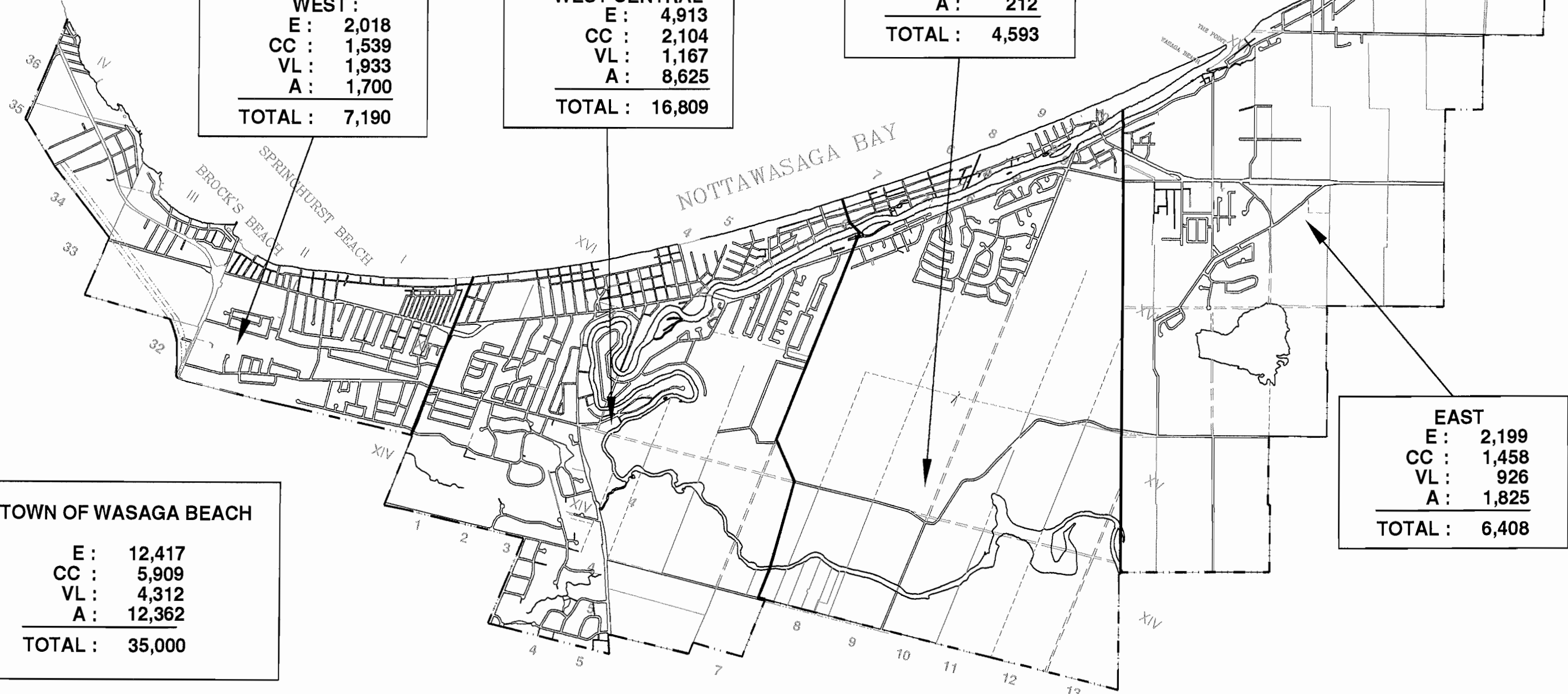

WEST :
E : 2,018
CC : 1,539
VL : 1,933
A : 1,700
TOTAL : 7,190

WEST CENTRAL
E : 4,913
CC : 2,104
VL : 1,167
A : 8,625
TOTAL : 16,809

EAST CENTRAL
E : 3,287
CC : 808
VL : 286
A : 212
TOTAL : 4,593

EAST
E : 2,199
CC : 1,458
VL : 926
A : 1,825
TOTAL : 6,408

TOWN OF WASAGA BEACH
E : 12,417
CC : 5,909
VL : 4,312
A : 12,362
TOTAL : 35,000

**REINDERS
SOUTHPARK**

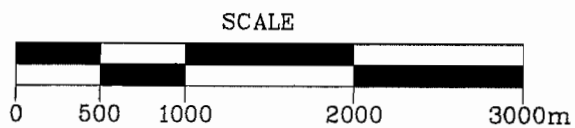

October 2004

E - EXISTING POPULATION (Based on 2001 Assessment and Census Data)
 CC - COTTAGE CONVERSION (Assumes 100% conversion)
 VL - VACANT LOT POPULATION (Existing and Approved)
 A - ADDITIONAL POPULATION ON VACANT LAND TOTAL

TOTAL POTENTIAL POPULATION
LEGEND

TOWN OF



WASAGA BEACH

Schedule 'F'

PLANNING AREA
 DESIGN POPULATIONS
 OFFICIAL PLAN FOR THE
 TOWN OF WASAGA BEACH

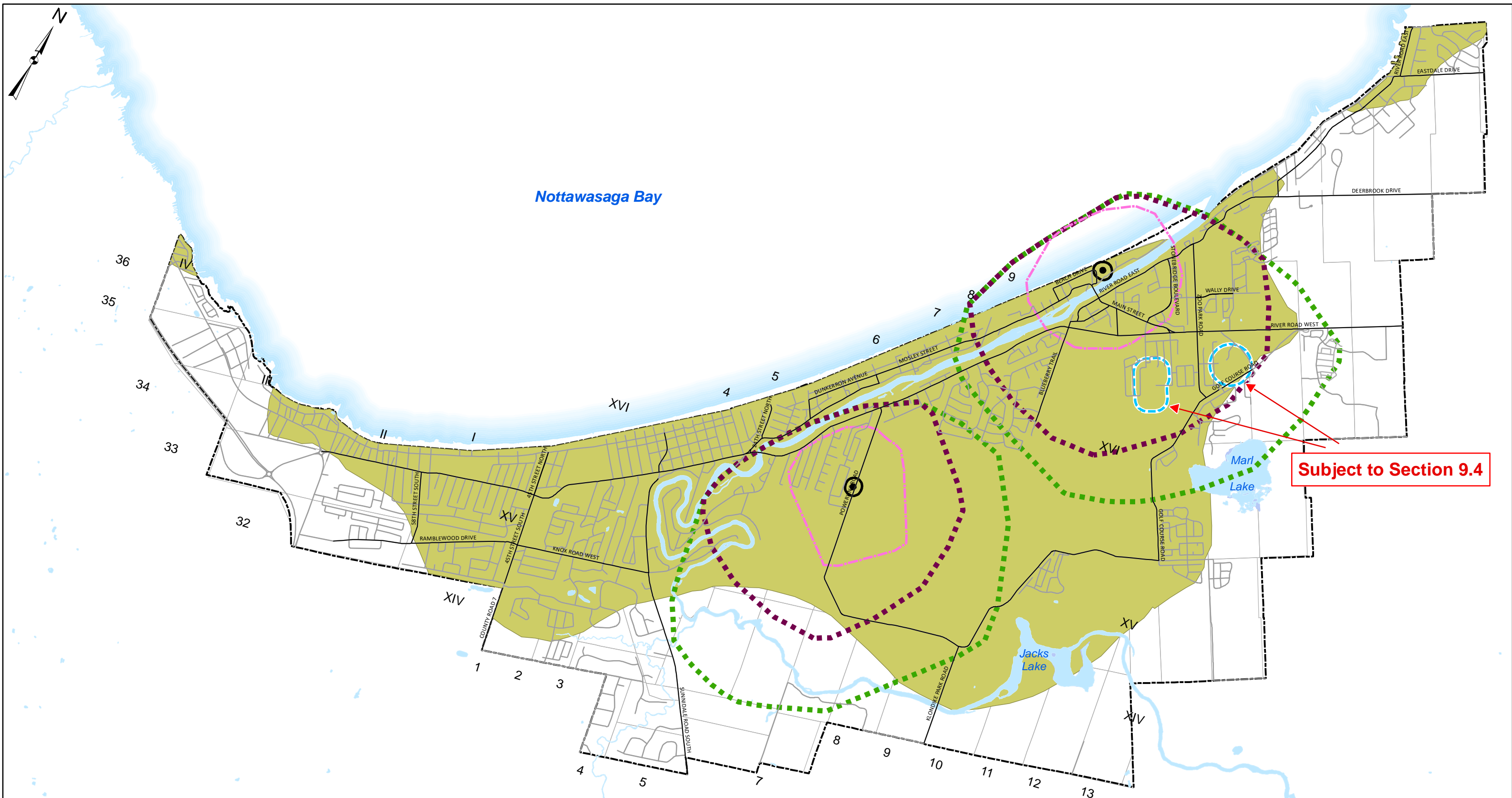

Adopted by Council: September 9, 2003

Approved by the County of Simcoe: June 22, 2004

Consolidated: January 2020

NOTE: The lot lines depicted on this map are for reference only and may not reflect accurately property boundaries in all instances.

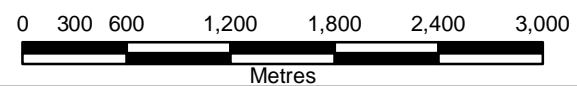

- Municipal Wells
- Well Head Protection Area-A: 100 Metre Fixed Radius Area Capture Zone
- ◻ Well Head Protection Area-B: 2 Year Capture Zone
- ◻ Well Head Protection Area-C: 2-10 Year Capture Zone
- ◻ Well Head Protection Area-D: 10-25 Year Capture Zone
- Area of High Aquifer Vulnerability
- ◻ Special Hydrogeological Study Area

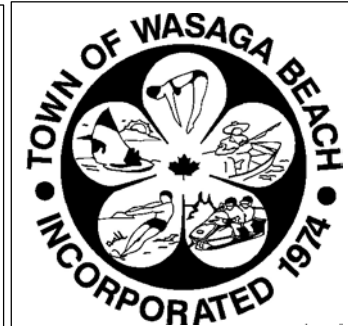

Schedule 'G'

Wellhead Protection Areas and Vulnerable Aquifer Areas

Official Plan for the Town of Wasaga Beach

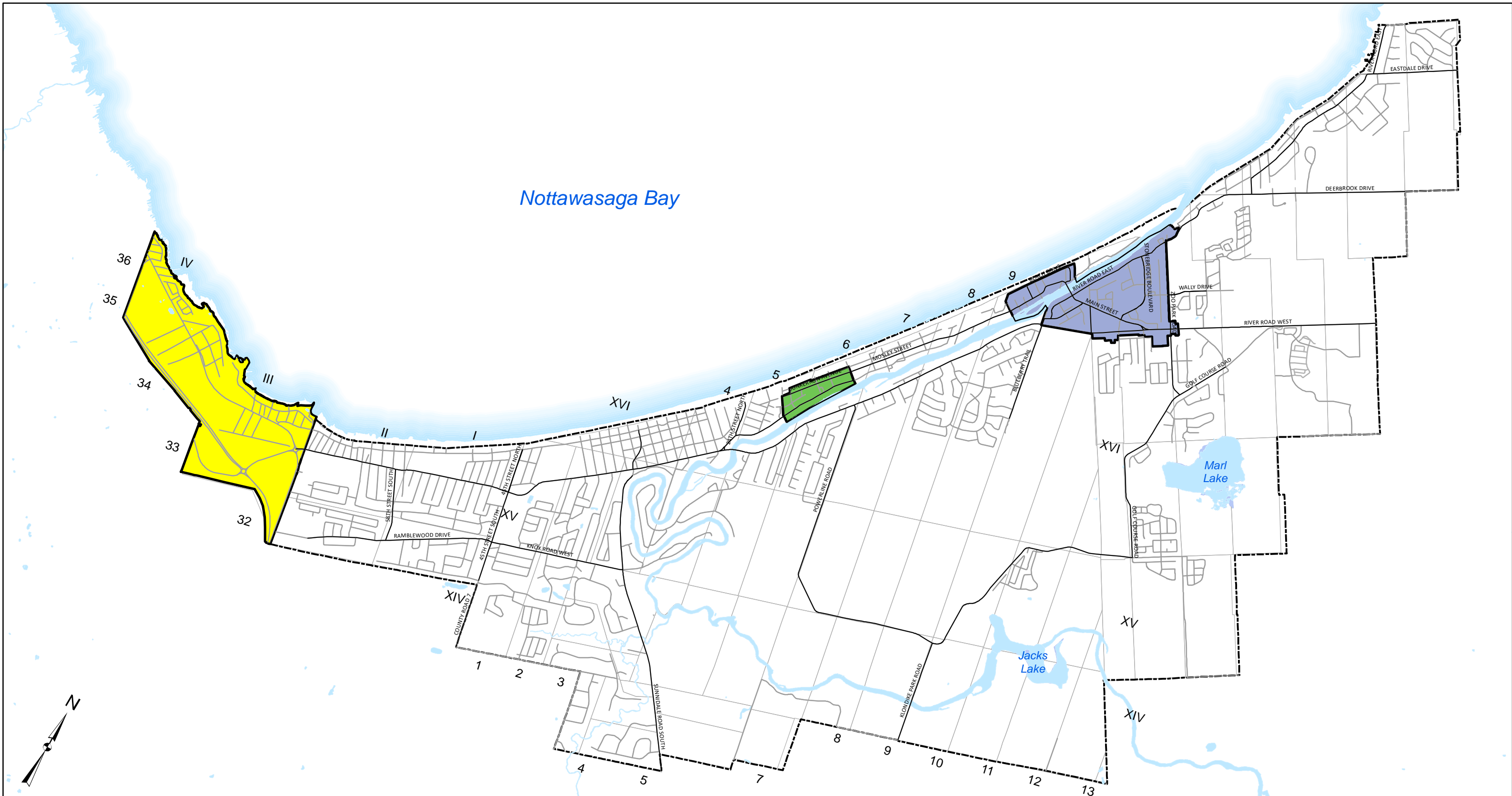

Adopted by Council: September 9, 2003

Approved by the County of Simcoe: June 22, 2004

Consolidated: January 2020

NOTE: The lot lines depicted on this map are for reference only and may not reflect accurately property boundaries in all instances.

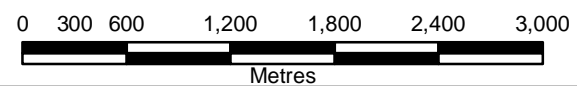

Legend

- Downtown Wasaga Community Improvement Project Area
- Mosley Village Community Improvement Project Study Area
- West End Community Improvement Project Study Area



Schedule 'H'

Community Improvement Project Areas

Official Plan for the Town of Wasaga Beach